

LABORATORY PERFUME FILLING SYSTEM TYPE: Z-2168



System equipment:

- Stainless steel table with an integrated pneumatic control for all working modules;
- Product filling module;
- Atomizers crimping module;
- Collars/rings inserting module;
- Connection lead for the product;
- Product pump (optional, depending on order);
- Atomizers tubes cutting device (optional, depending on order).



Operational parameters

Production capacity: 600 ÷ 1200 pcs/h (10 ÷ 20 pcs/min) – for max 100 ml filling dose. Effective capacity depends on filling dose, production organization and operator's experience

Range of dosage: Up to 100 ml in standard

Crimping type: Standard or vacuum (additional option)

Dimensions and weight

Width: 3075 mm

Length: 905 mm

Height: 1840 mm (+/- 50 mm of adjustment)

Mass: 366 kg

Supply

Supply type: Pneumatic

Air supply pressure: 0.8 ÷ 1.0 MPa (8 ÷ 10 bar)

Air consumption (for capacity 1200 pcs/h): 75 litres/min (4.5 m³/h); Manufacturer recommends compressor able to deliver around 115 litres/min @ 10 bar

Compressed air quality: CLASS IV according to ISO 8573-1 for 15 ÷ 35°C

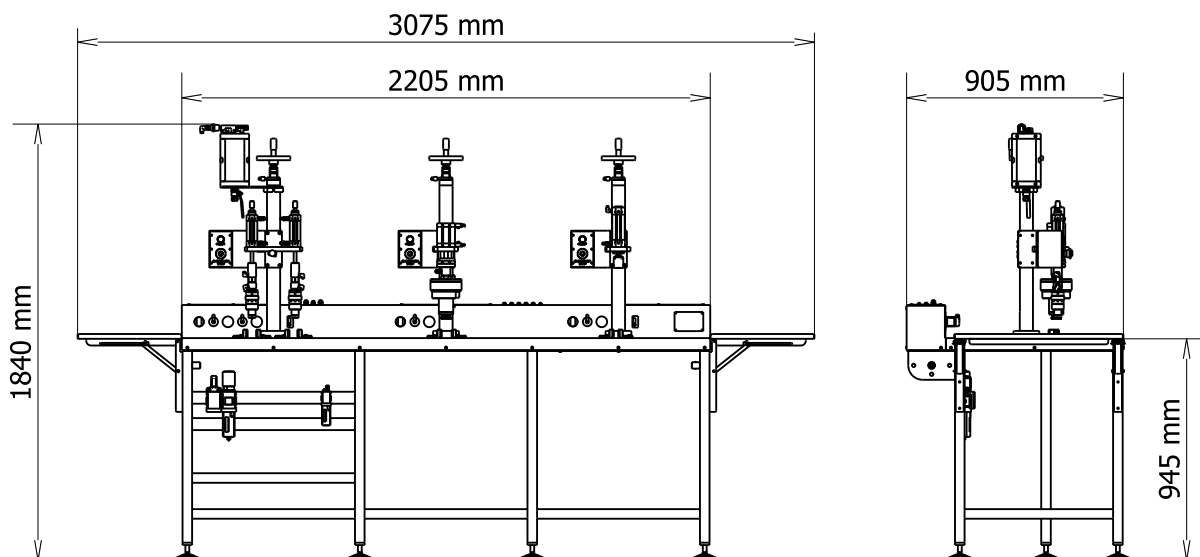

ZIGLER POLSKA Sp. z o.o.

ul. Braci Gutmanów 7

43-600 Jaworzno

POLAND

+48 32 616 36 70

biuro@zigler.pl

zigler@zigler.pl

www.zigler.pl

VAT UE: PL6772294223

REGON: 120491798

KRS: KRS nr 0000032816

Sąd Rejonowy Katowice-Wschód
w Katowicach

BANK ACC.

ING BANK ŚLĄSKI

PLN 56 1050 1360 1000 0090 3033 8132

EUR 94 1050 1360 1000 0024 0995 9893

SWIFT: INGBPLPW